



COMMERCIAL SITE FOR SALE

Cor Sawyer Lane & SR 54, New Port Richey, 34652 - PASCO COUNTY



Size: 3.1 Acres—
Zoned: C2 Commercial
Parcel ID: 20-26-16-0000-03900-0000
Traffic Count : AADT 34,000
Price \$565,000

County records show no Wetlands. Access from three sides—SR 54 and both sides of Sawyer Lane. 120 ft frontage on SR 54. Water is on SR 54. Sewer is close.



For more information contact:

Steven Silverman, MBA. CCIM.

Fax (813) 435-2004 Cell: 813-785-3665

email: Steven@TampaCommercialRealestate.com

Information herein has been obtained from sources deemed reliable. We cannot guarantee accuracy. Subject to change or withdrawal without notice.

**TAMPA COMMERCIAL
Real Estate**

www.TampaCommercialRealestate.com

ADDRESS: Sawyer Rd & SR 54,

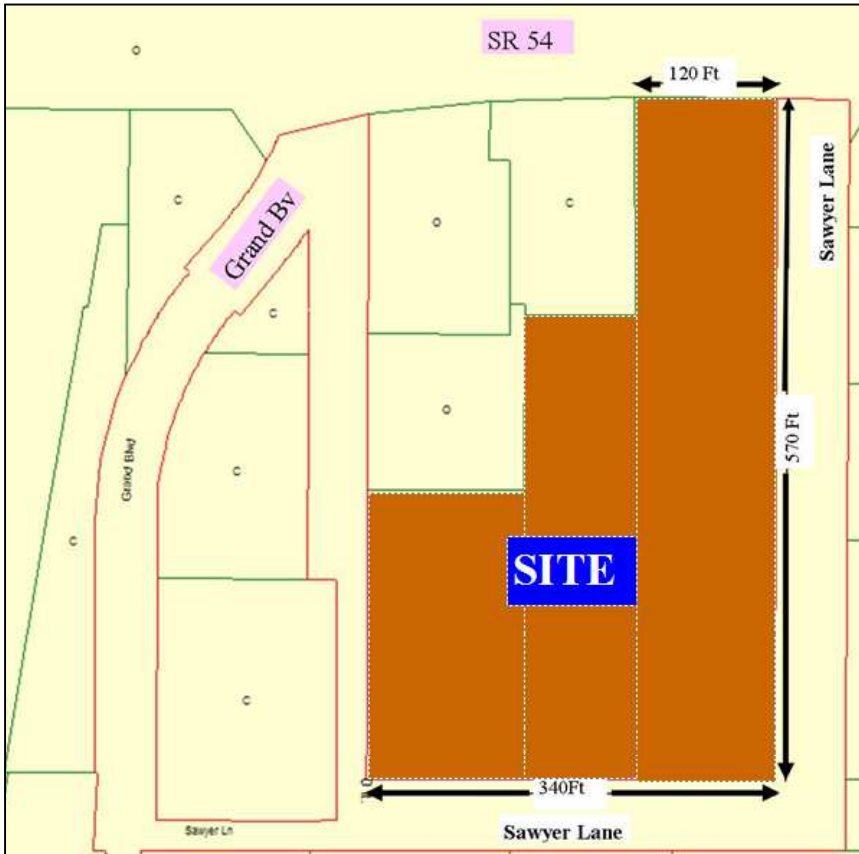

2012	1 MILE	3 MILES	5 MILES
POPULATION	12,450	80,100	139,515
HOUSEHOLDS	5,022	35,381	60,473
MED AGE	40.9	45.9	46.4
MED HH INCOME	\$36,042	\$35,328	\$37,734
AV HH INCOME	\$42,948	\$46,776	\$52,984

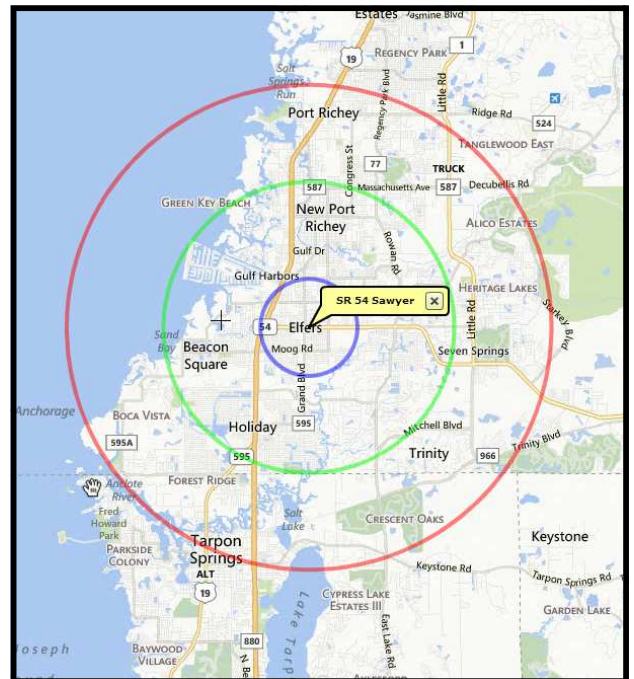
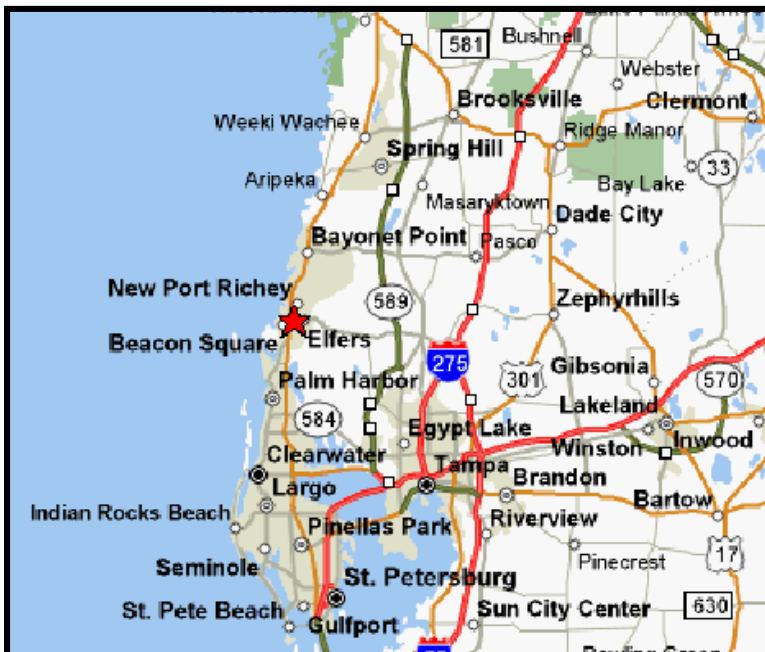

Steven Silverman, MBA. CCIM.

email: Steven@TampaCommercialRealestate.com

Information herein has been obtained from sources deemed reliable. We cannot guarantee accuracy.

**TAMPA COMMERCIAL
Real Estate**